

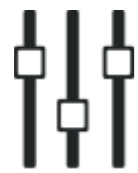

Device to safeguard life



Measure



Control



Record



Analyze



Voltage Relay



Line Monitoring Relay



Current Relay



Earth Leakage Relay



Voltage Relay



Current Relay



Phase Failure Relay



Earth Leakage Relay

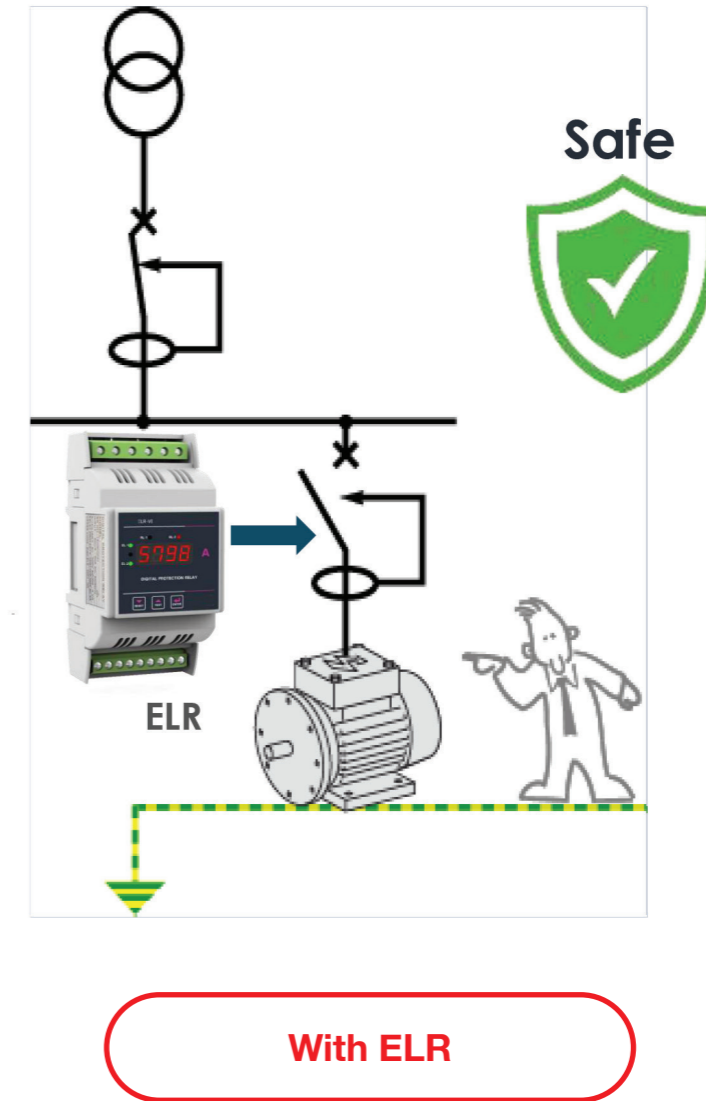
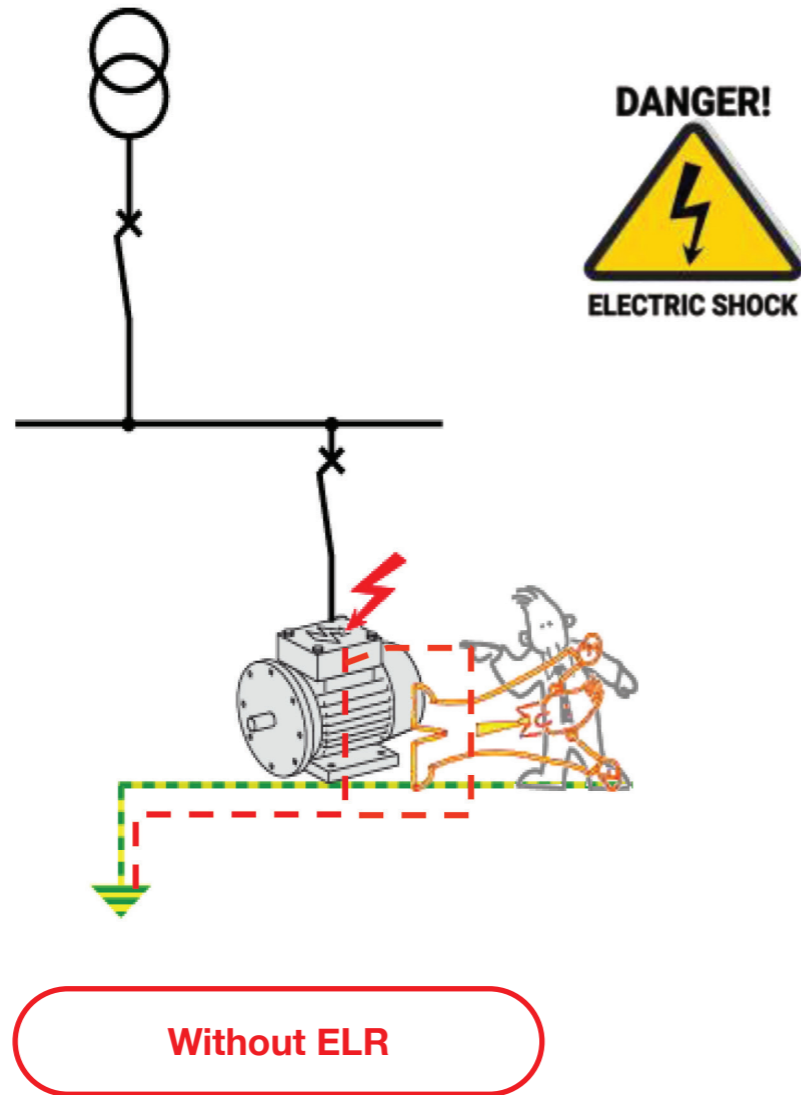



Selec
ELRA2M

Minilec
S2 ELR2



GIC
17G715GF2

Veritek
VIPS 98P



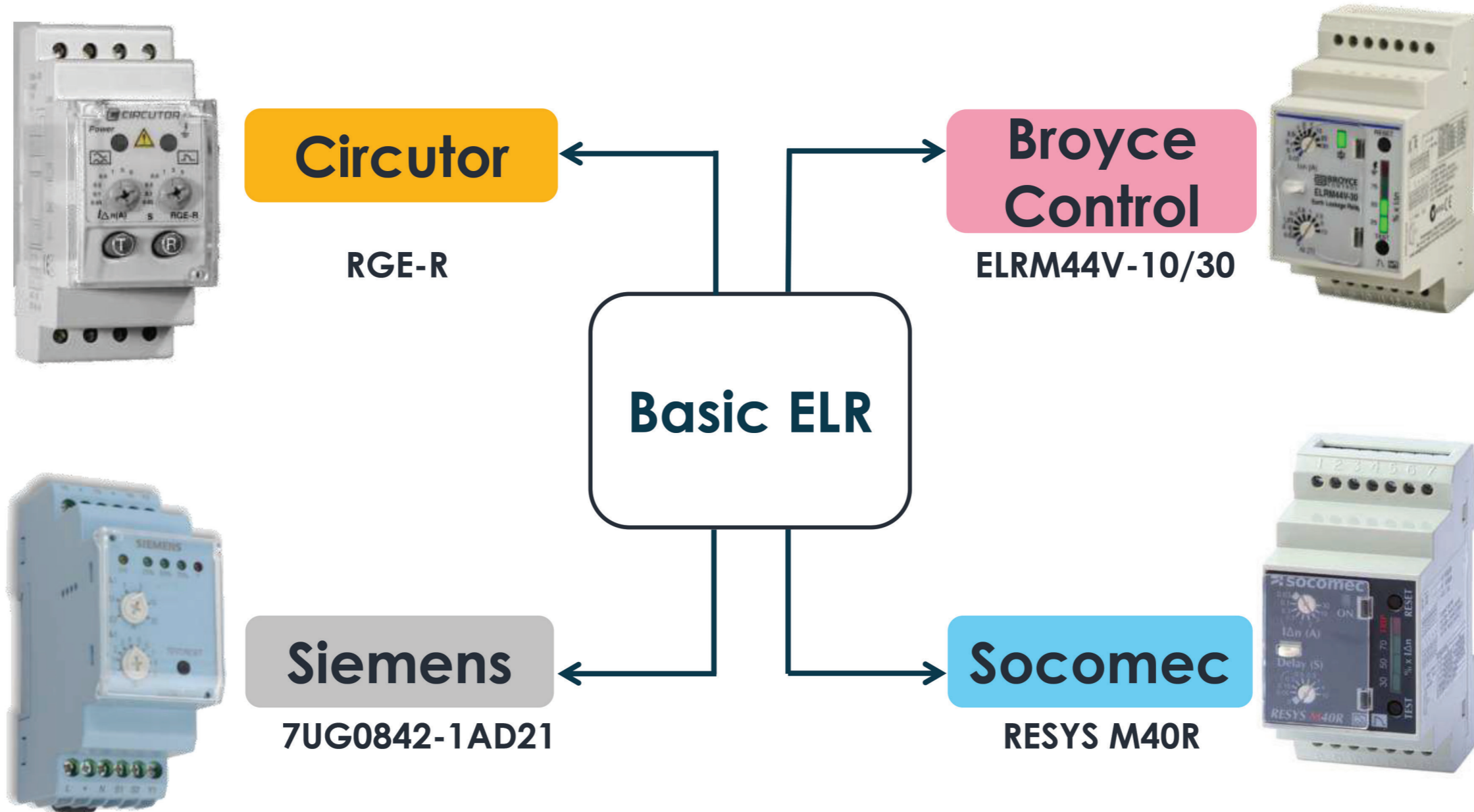

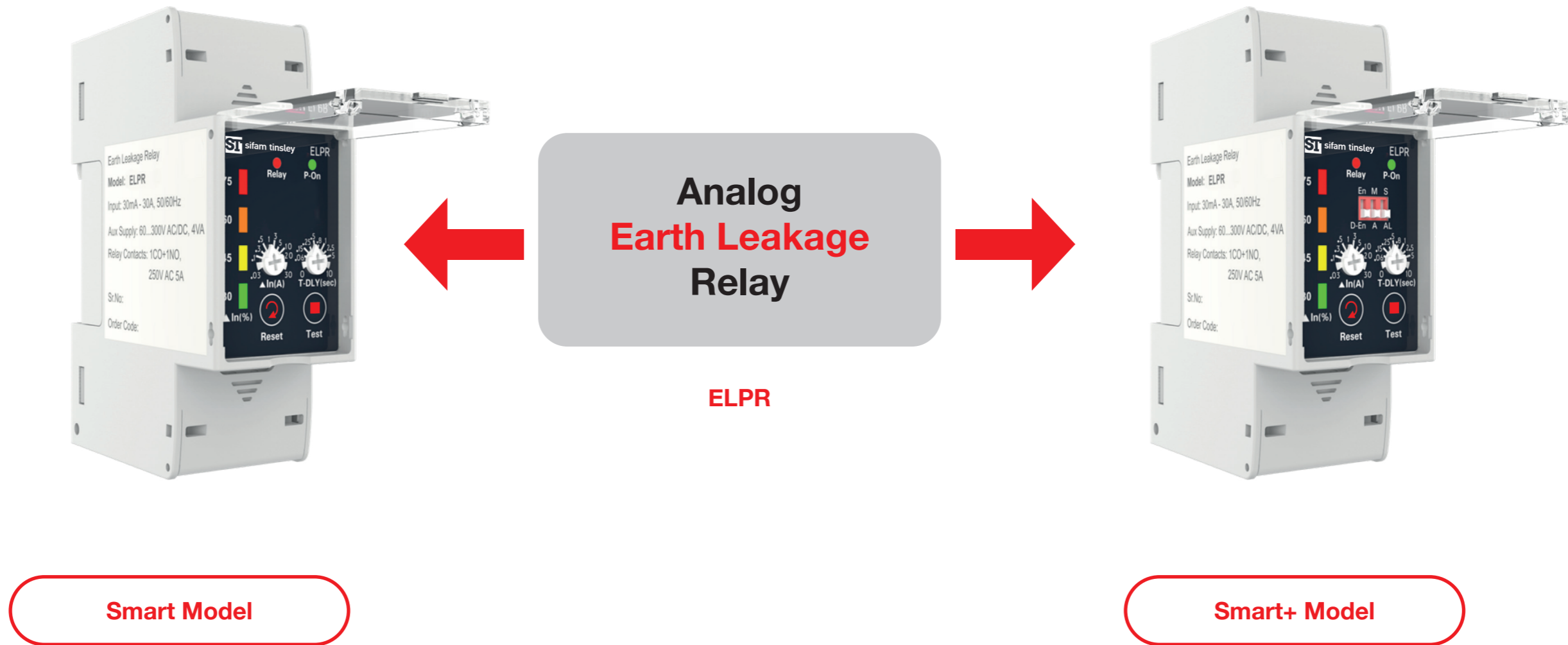

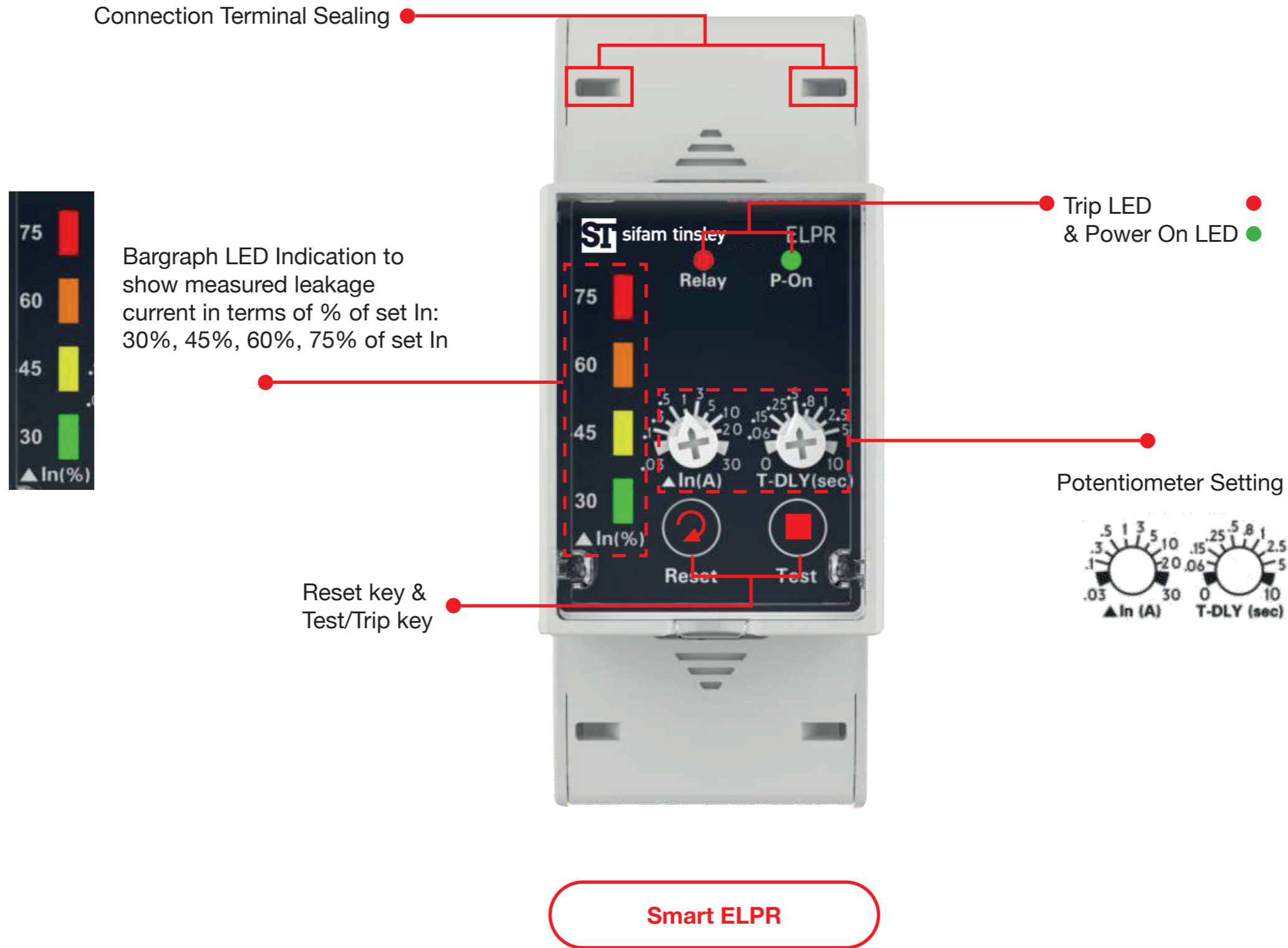

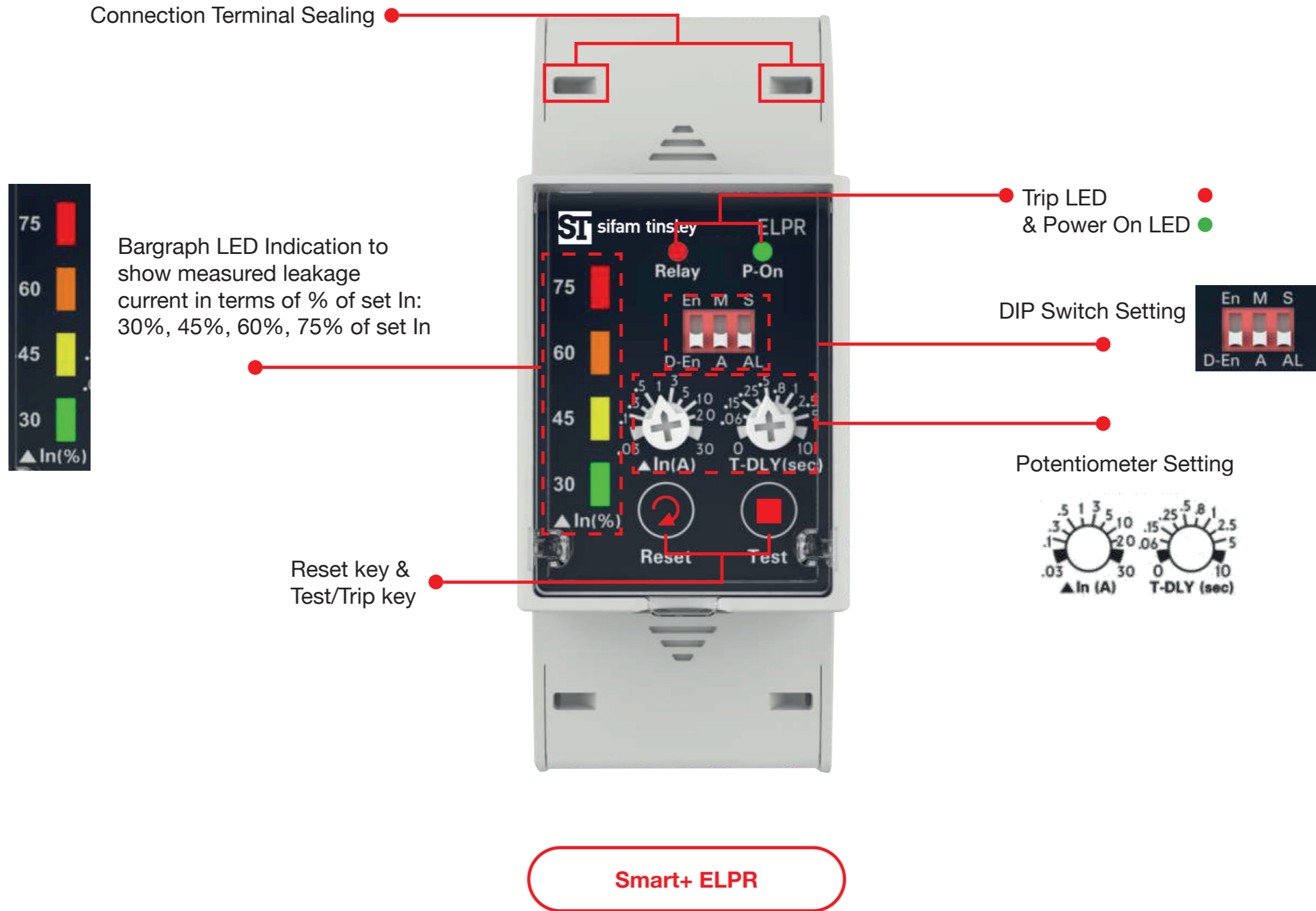



Onsite Programmable

Can be programmed through potentiometer
 1 Leakage current 30mA to 30A
 2 Trip Time 0 to 10 sec



Leakage current trip limit can be set from 30mA to 30A



Trip Delay can be set from 0 to 10 sec

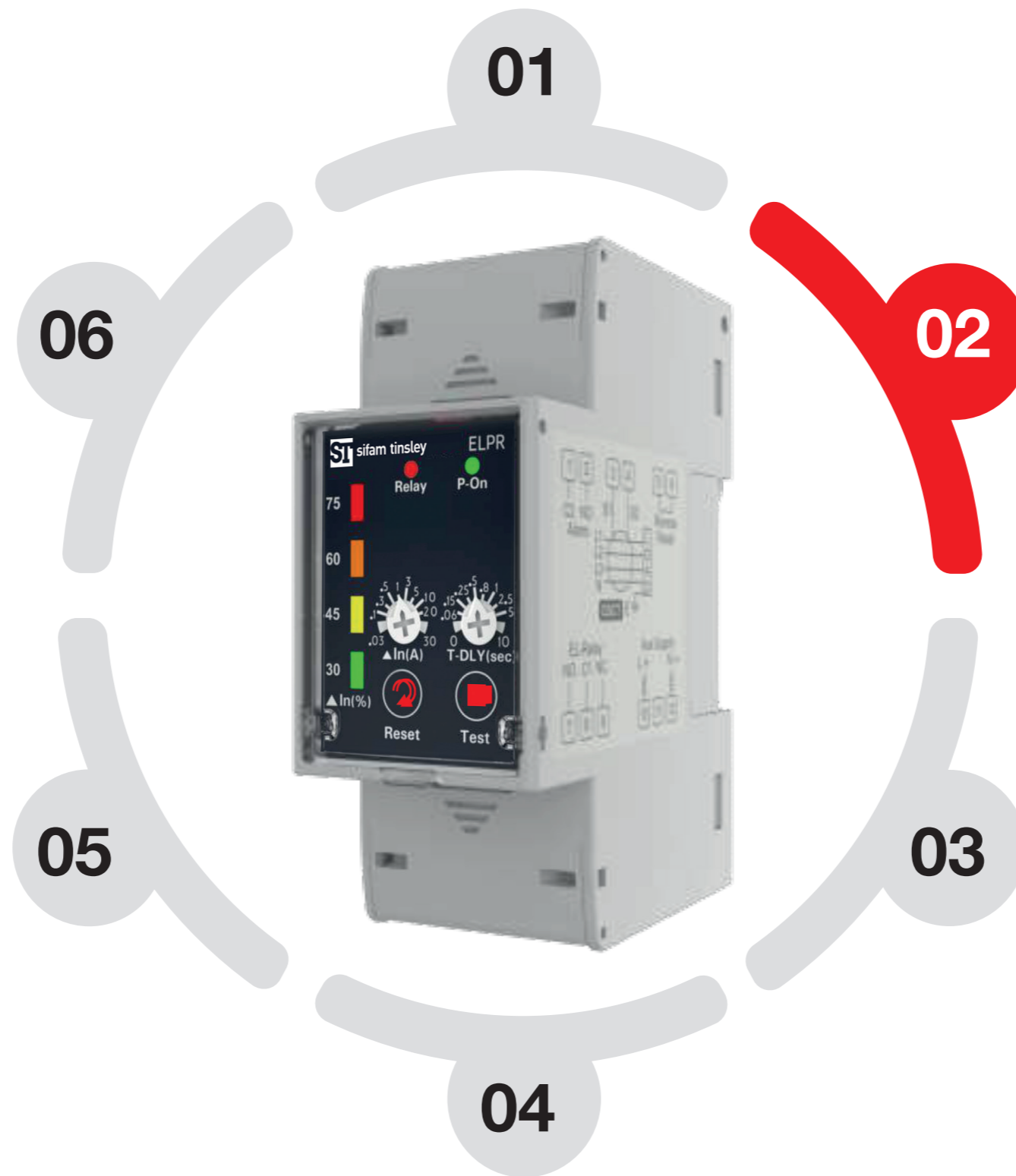

Bargraph Indication

Bargraph LED Indication to show measured leakage current in terms of % of set In
30% 45% 60% 75% of set In



For example:
Set Current In = **1A**

When measured leakage current reaches to

30% of 1A = **0.3A** 45% of 1A = **0.45A** 60% of 1A = **0.60A** 75% of 1A = **0.75A**



Status of Bargraph LED

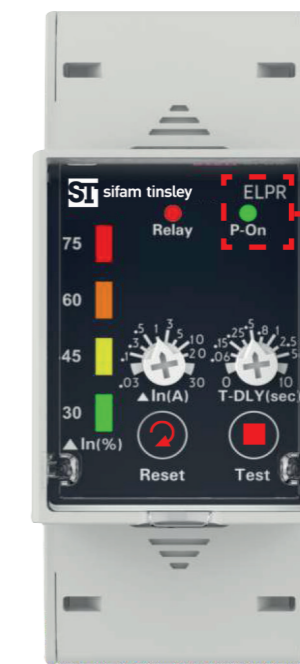

P On LED
1) Continuous: **Power ON**
2) Blinking: **CBCT Open condition detected**

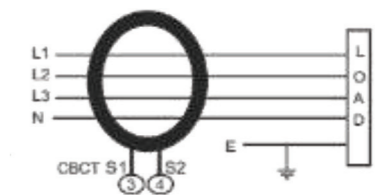

CBCT Fault Detection

CBCT connections are monitored by ELR, so that leakage current detection is always accurate.

PON LED Blinking CBCT Open condition detected.



Remote Reset

A separate relay contact is provided at terminal block which can be used for remote resetting of Relay.

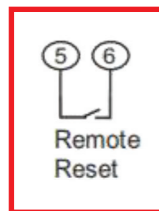



Wide Auxiliary Supply

To suit all grid conditions

1. Higher:- 60V - 300V AC/DC
2. Lower:- 20 - 60V DC / 20-40 VAC

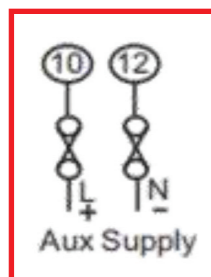



DIP Switch

In Smart+ Version Only

1. Main Relay (1CO) Configuration Energized / De-energized
2. Auto Re-closure (Reset) / Manual Reset
3. Additional Relay (1NO) Configuration Fail safe or Alarm Relay

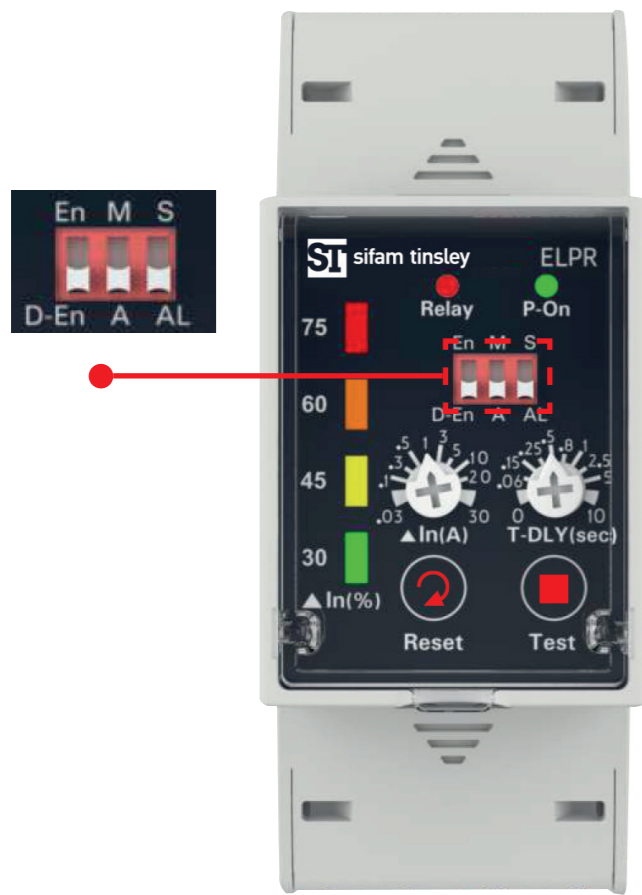

Smart+





DIP Switch

In Smart+ Version Only

1. Main Relay (1CO) Configuration Energized / De-energized
2. Auto Re-closure (Reset) / Manual Reset
3. Additional Relay (1NO) Configuration Fail safe or Alarm Relay

Wide Auxiliary Supply

To suit all grid conditions

1. Higher:- 60V - 300V AC/DC
2. Lower:- 20 - 60V DC / 20-40 VAC

Remote Reset

A separate relay contact is provided at terminal block which can be used for remote resetting of Relay.



Onsite Programmable

Can be programmed through potentiometer

- 1 Leakage current 30mA to 30A
- 2 Trip Time 0 to 10 sec

Bargraph Indication

Bargraph LED Indication to show measured leakage current in terms of % of set In 30% 45% 60% 75% of set In

CBCT Fault Detection

CBCT connections are monitored by ELR, so that leakage current detection is always accurate.

PON LED Blinking CBCT Open condition detected.



Leakage Current :- 30mA to 30A through CBCT

Leakage current :- 5% of FS
Trip Delay :- 5% of set trip time or 50ms

Main Relay :- 1 NO + 1 NC (1 CO)
Additional Relay:- 1 NO
Remote Reset Relay :- Non potential free
(Voltage:- 12VDC)
Rating:- 5A / 250 VAC or 30VDC



Higher :- 60 to 300V AC/DC
Lower :- 20 to 60V DC / 20 to 40V AC

Product standard :- IEC 60947-2
EMI EMC :- IEC 61326-1:2012
Safety :- IEC 61010-1-2001



1. Energized / De-energized

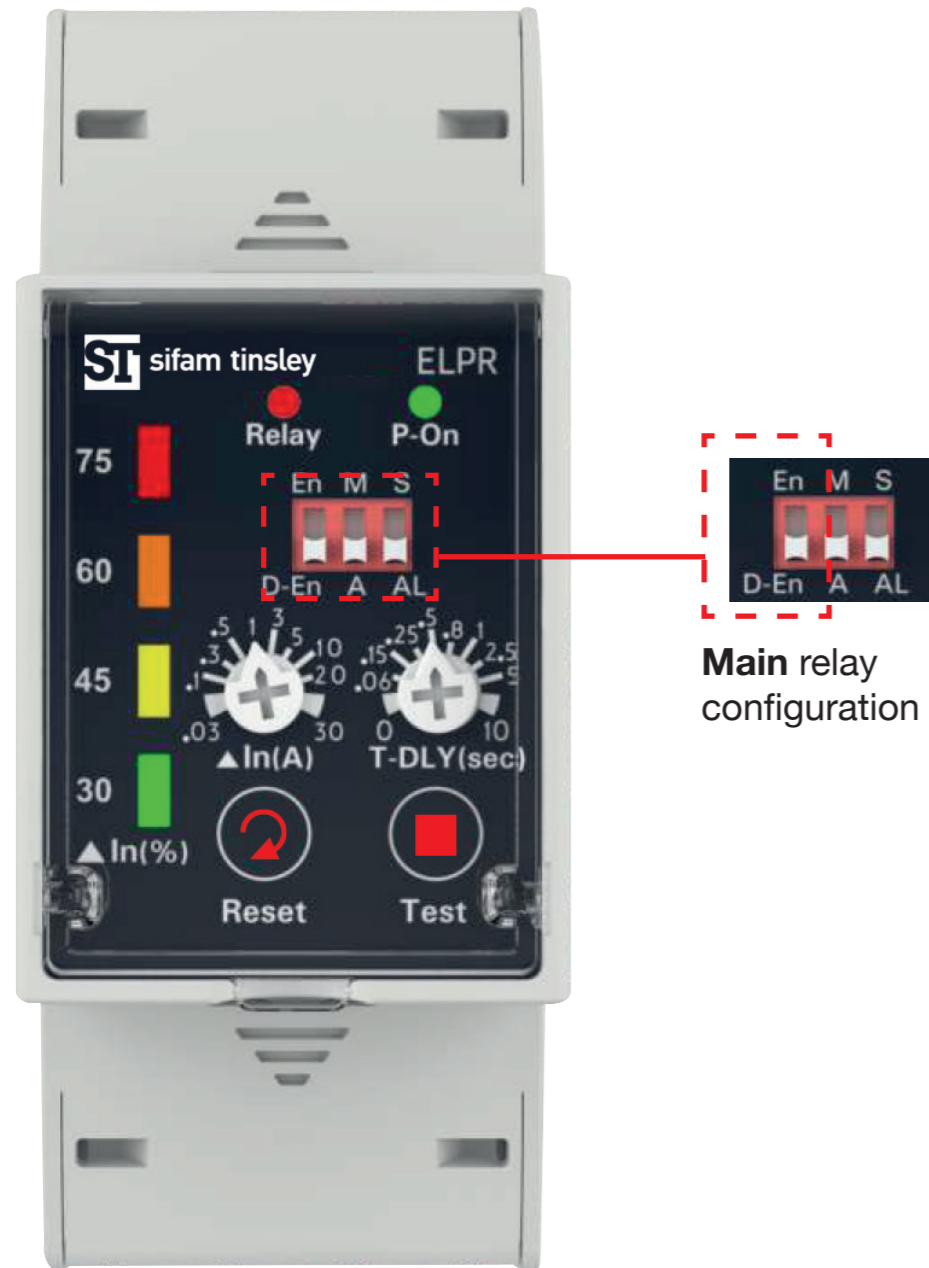

Energized Configuration :- In fault condition main relay contacts will get energized (COM & NO contacts are shorted)

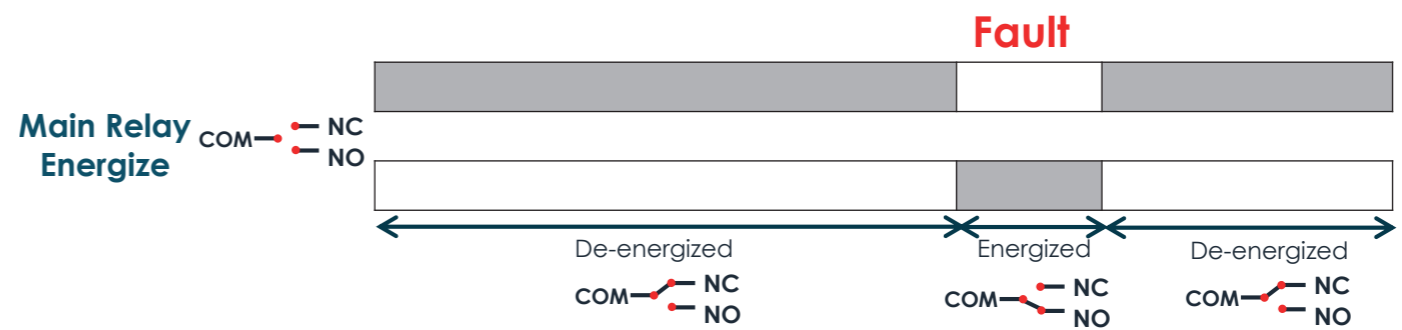

De-energized Configuration :- In fault condition main relay contacts will get De-energized (COM & NO contacts are open)

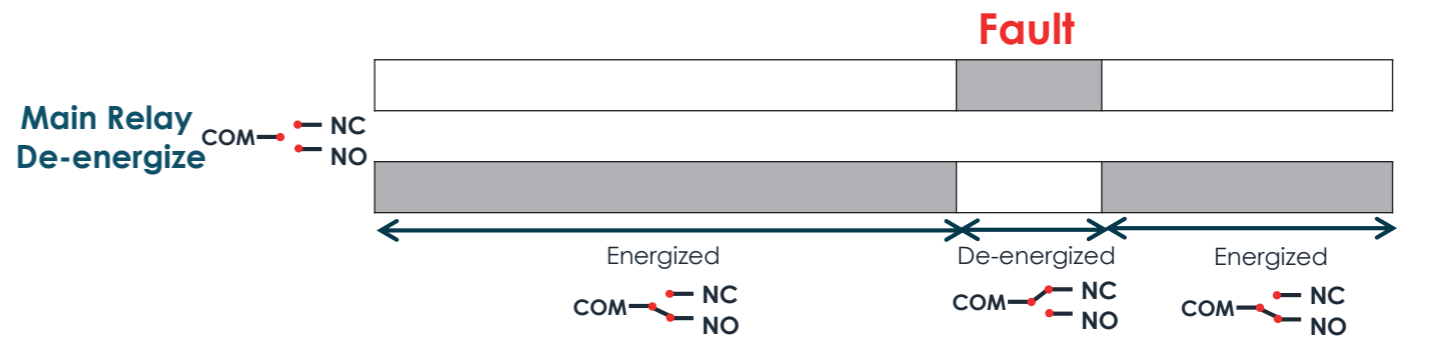

Note :- OFF (open) - ON (shorted) -



2. Auto / Manual Reset

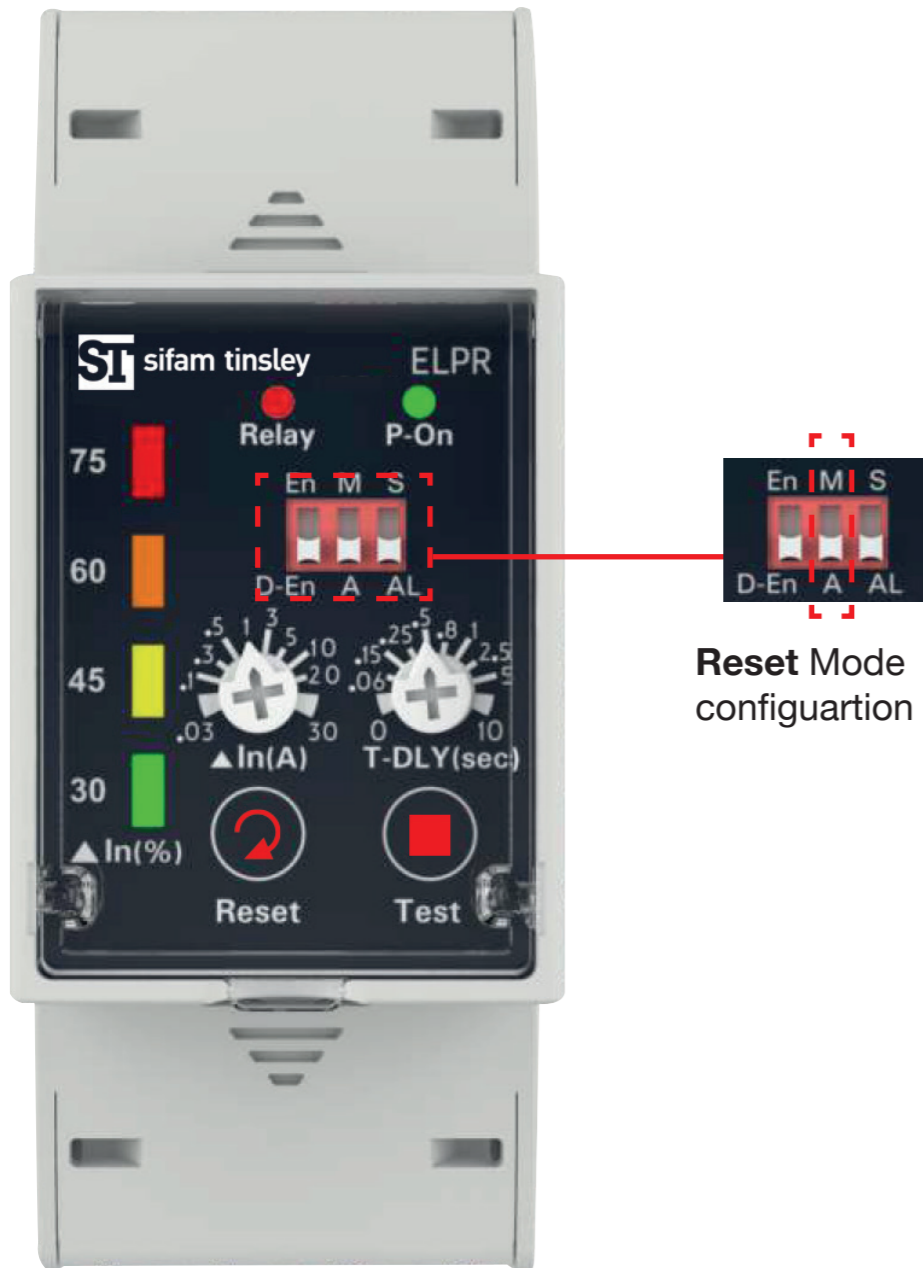

Manual Reset :- If the ELR is set to manual mode, then the relay must be reset manually by using Reset Key after clearing the fault condition.



Auto Reset :- In auto reset mode ELR automatically tries to re-connect load to system by making 3 reclosure attempts (10 sec fixed interval between two attempts) after occurrence of fault.

- 1) During this if fault is cleared then relay resets automatically.
- 2) If the fault still continues after 3 attempts, then relay is tripped permanently. In that case relay has to reset manually for further operation.

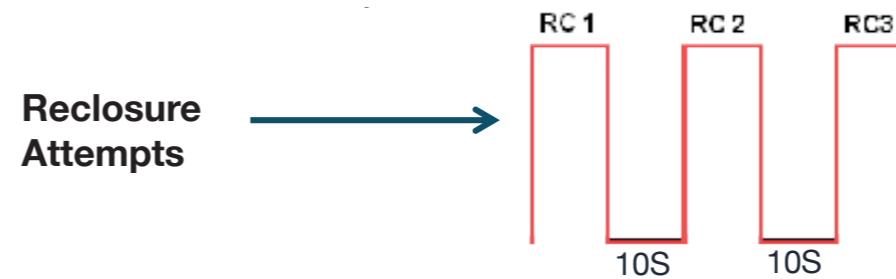



3. Fail safe or Alarm Relay

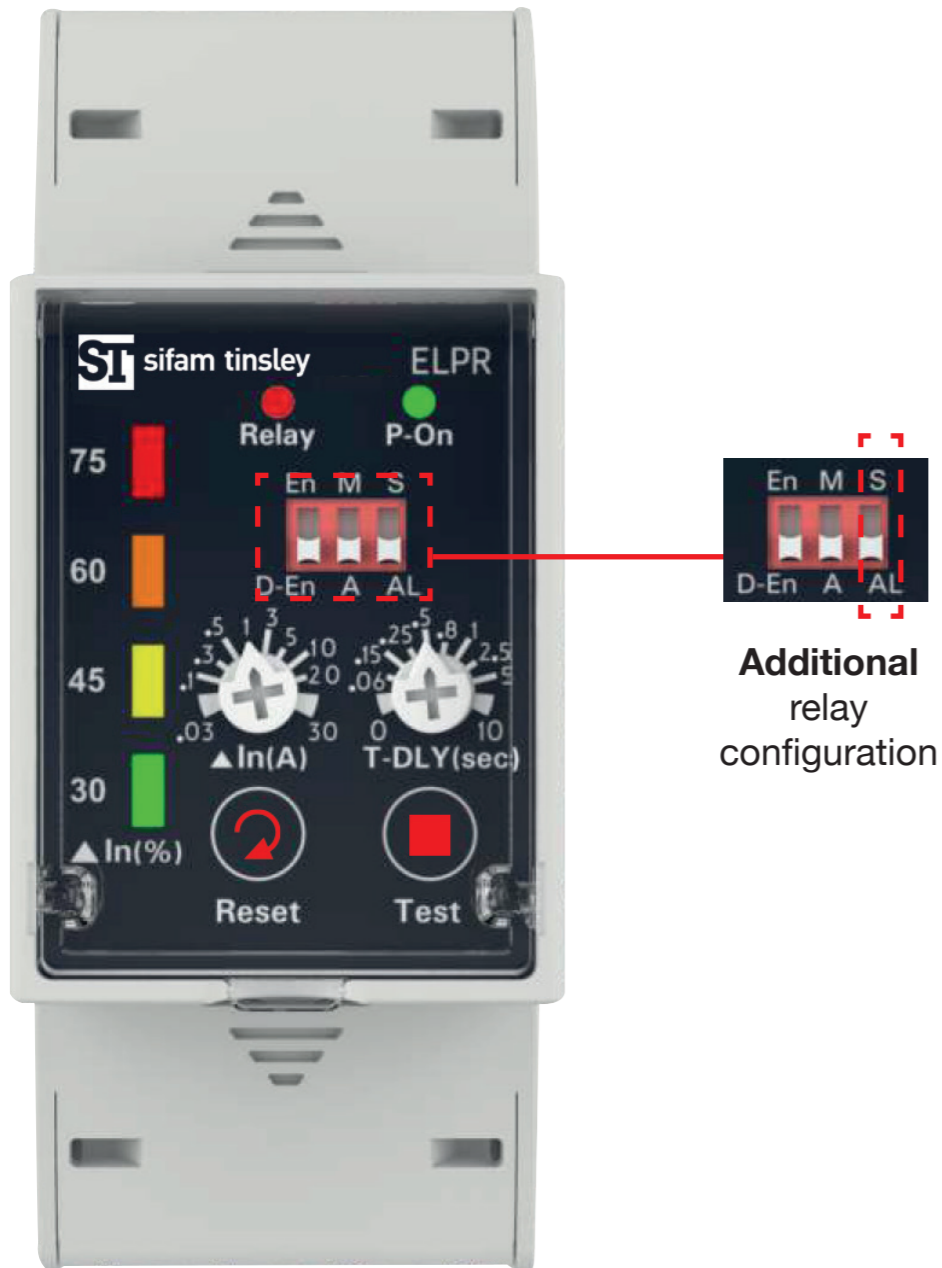

Additional
relay
configuration

Fail Safe Relay :- Relay represents the state of auxiliary supply condition. It trips when auxiliary supply to the ELR interrupts.

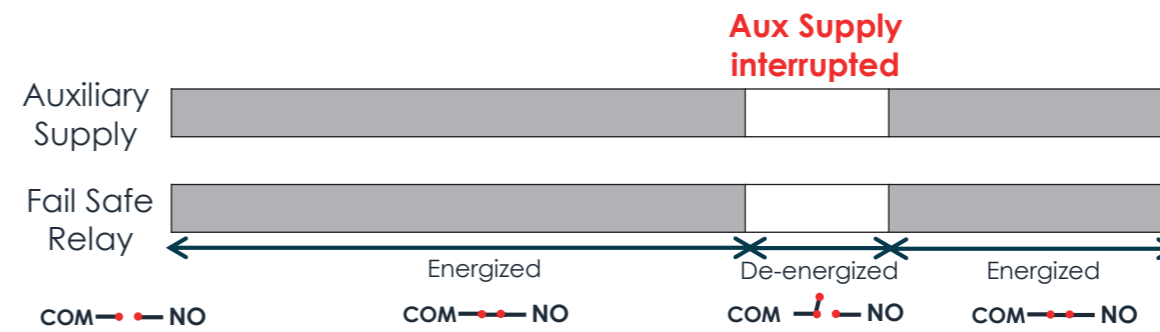

Alarm Relay :- If leakage current exceeds 50% of set value, alarm relay is activated in order to trigger suitable indications connected (Alarm / Buzzer)

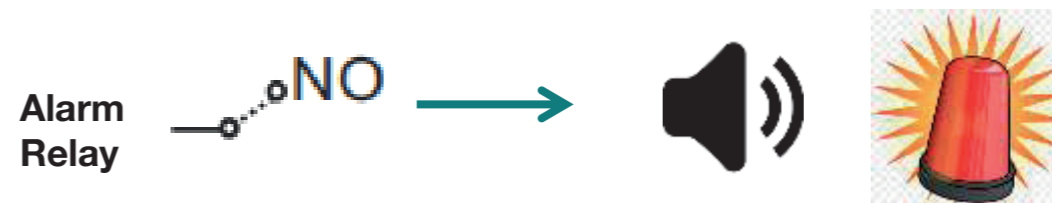

Note :-OFF (open) - ON (shorted) -



Smart ELPR - Main Relay Configuration

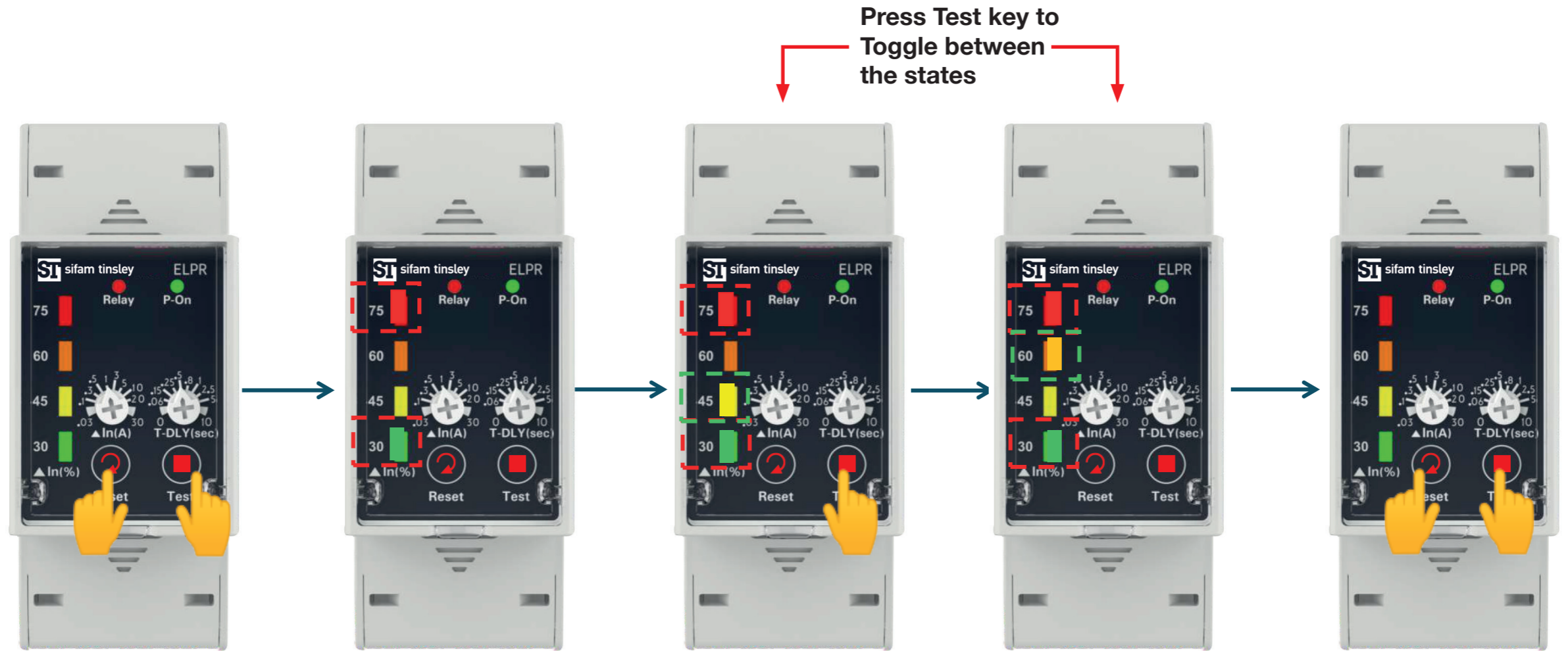

Press Test key to
Toggle between
the states

Press both keys simultaneously for more than 3 seconds

Setting is activated is indicated by blinking of Bargraph 75% & 30% LED (at rate of 0.5 sec)

If 45% LED ON & then relay is configured as Energized state

If 60% LED ON & then relay is configured as De-energized state

To confirm state setting press both keys simultaneously for more than 3 seconds



Smart & Smart+ ELPR - Alarm Relay Configuration

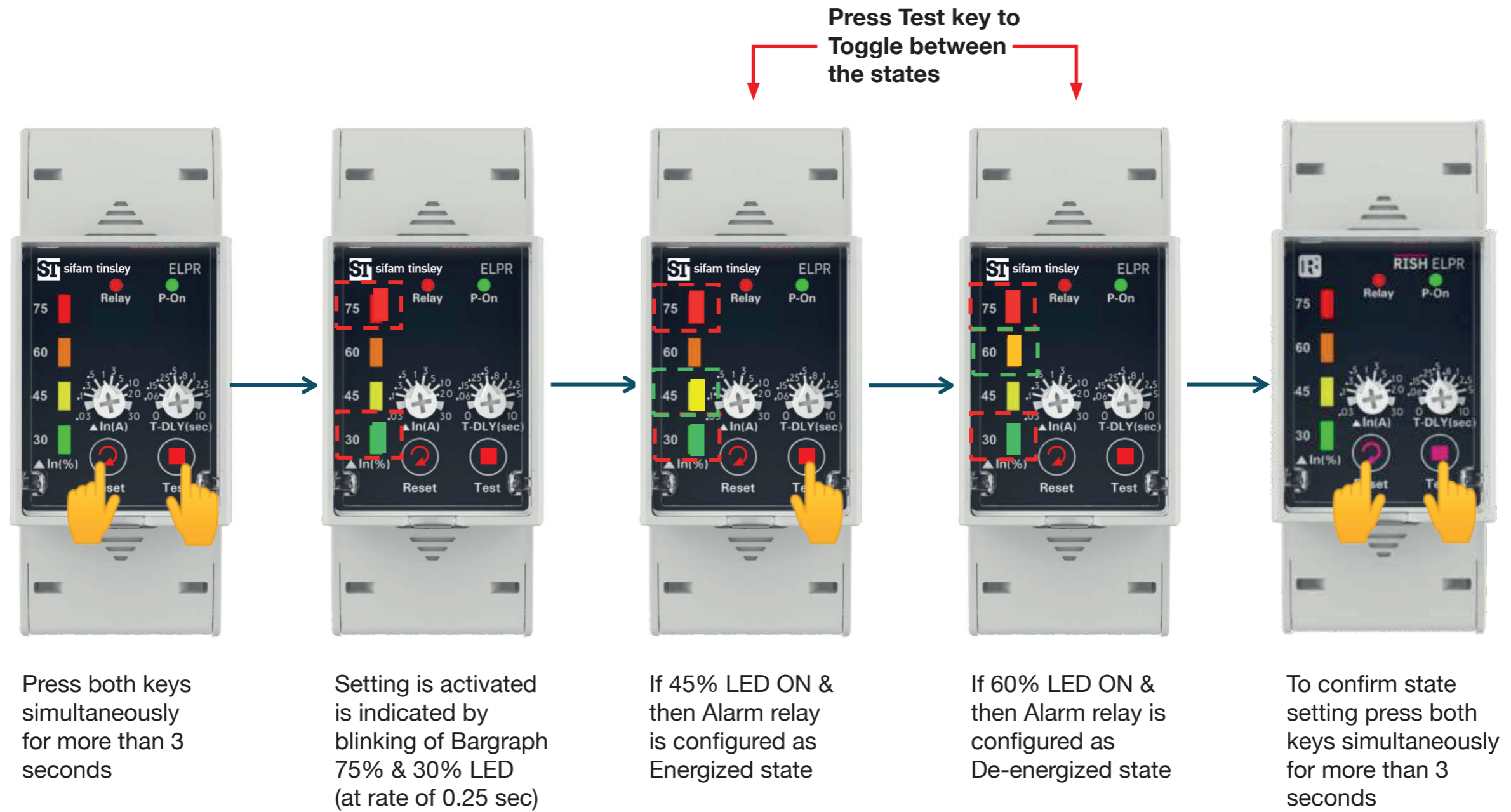



ELPR - Earth Leakage Relay

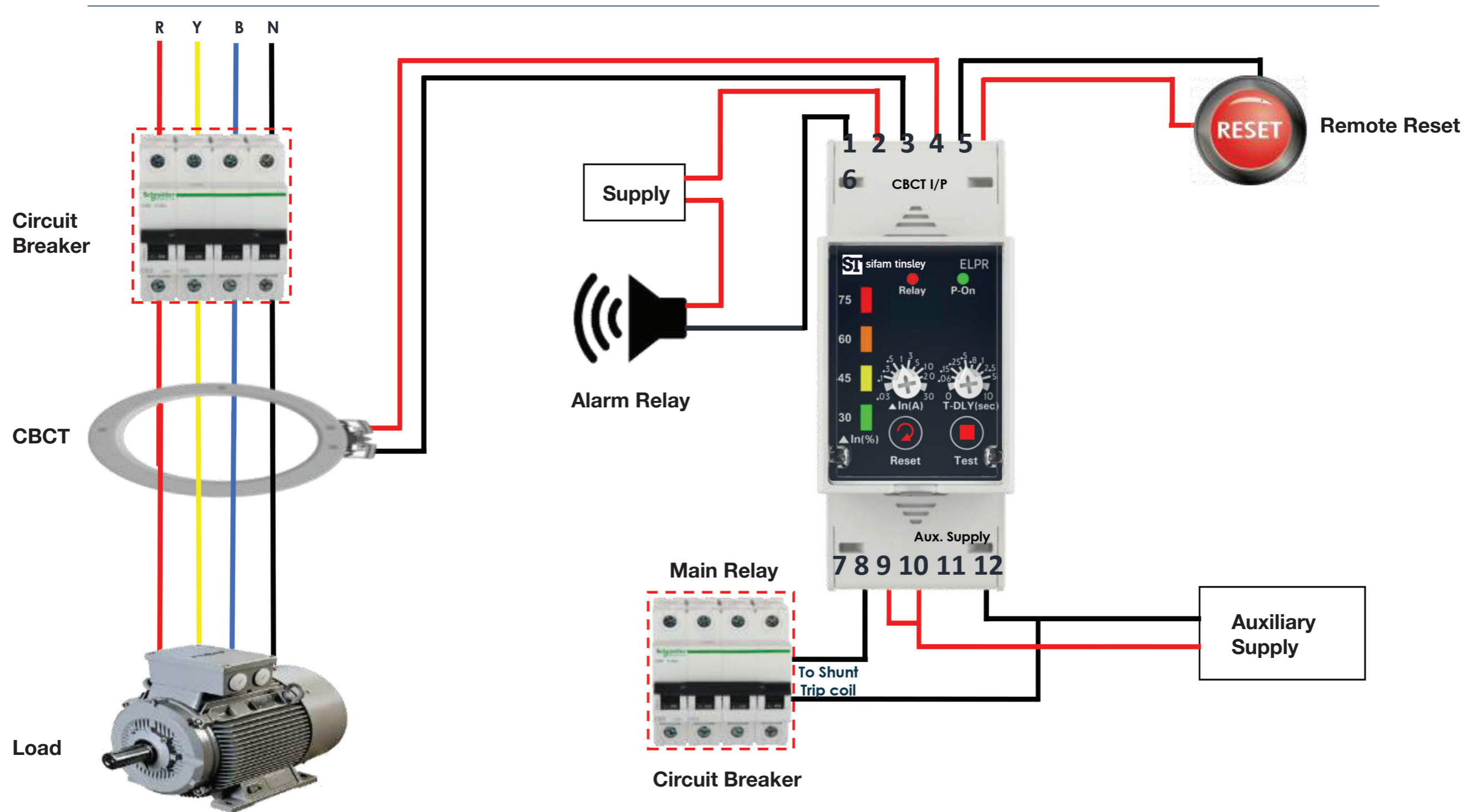

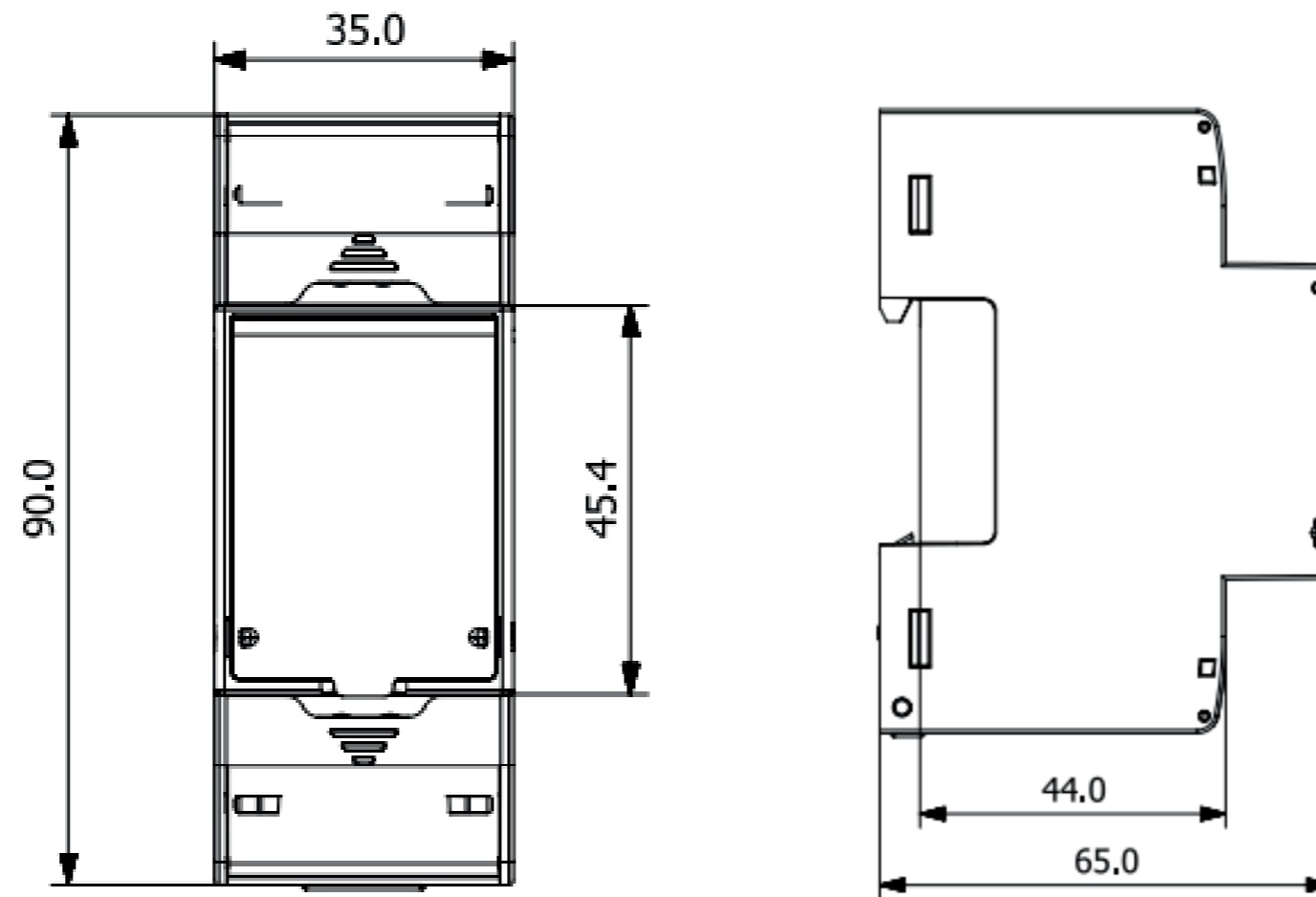

All Dimensions are given in mm



Motor Control Panel



Mining Industry



Cement Industry



Sifam Tinsley Instrumentation Ltd

1 Warner Drive
Springwood Industrial Estate
Braintree
Essex
CM7 2YW

Tel: 01376 335271
Email: sales@sifamtinsley.com

www.sifamtinsley.co.uk